

FOUNDATION PLAN
1/4" = 1'-0"

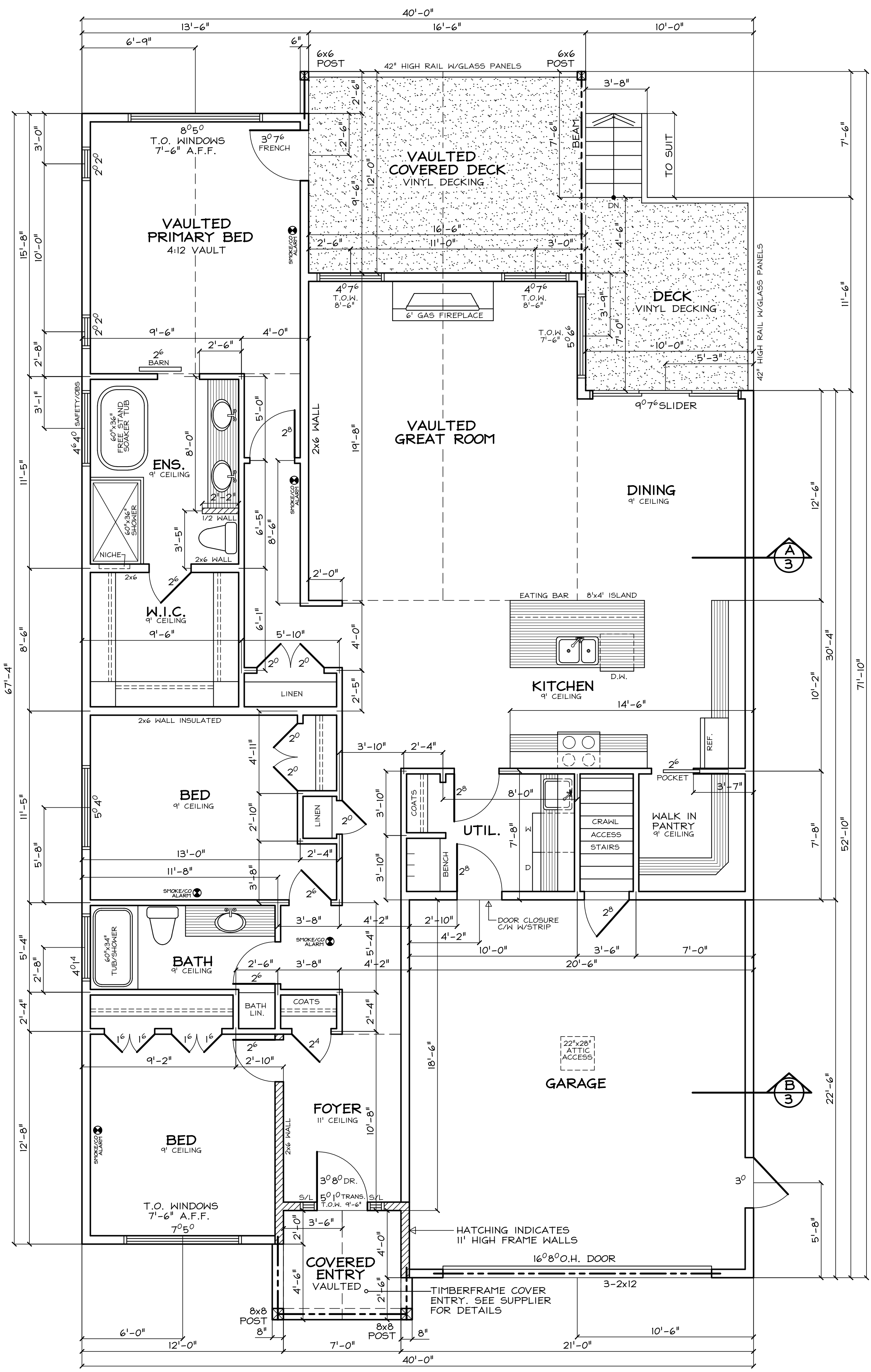

MAIN FLOOR PLAN
1/4" = 1'-0"
1912 SQ. FT.

GENERAL NOTES
 VERIFY ALL DIMENSIONS PRIOR TO CONSTRUCTION.
 ALL CONSTRUCTION TO COMPLY TO THE B.C.B.C 2018
 FLOOR JOISTS, LINTELS (2-2x10)# BUILT UP BEAMS TO BE SPF #2 OR BETTER.
 FLASH, RAINSCREEN & CAULK AS REQUIRED TO ENSURE A WEATHER TIGHT BUILDING.
 ELECTRICAL, MECHANICAL AND PLUMBING TO BE SPEC'D BY OWNER.

CONSTRUCTION NOTES
 1. INTERIOR ROOM DIMENSIONS MAY VARY SLIGHTLY FROM PLAN. CONFIRM WITH CONTRACTOR.
 2. REFER TO TRUSS SUPPLIER LAYOUT FOR POINT LOAD LOCATIONS AND GIRDER TRUSSES. ENSURE PROPER BEARING AS REQUIRED.

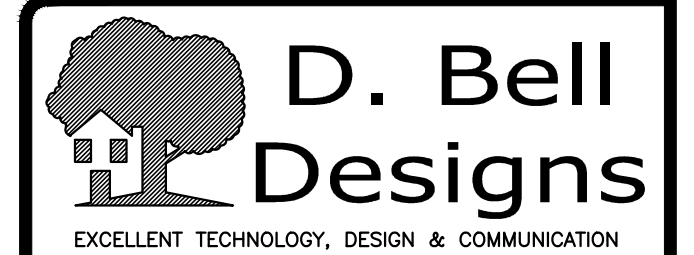

PHONE: (250) 338-2748
 EMAIL: darin.bell@shaw.ca

CLIENT:
HAMILTON BROTHERS CONTRACTING Ltd.
 LOT 1, 3356 MARYGROVE PLACE
 COURTENAY, B.C.

MAIN FLOOR PLAN & FOUNDATION PLAN

DATE	DWN.	DWG. NO.
JUNE 22, 2023	DLB	2 OF 3